

Soil Map—Oneida County, New York

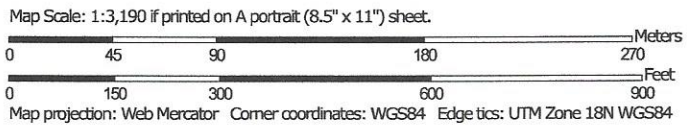
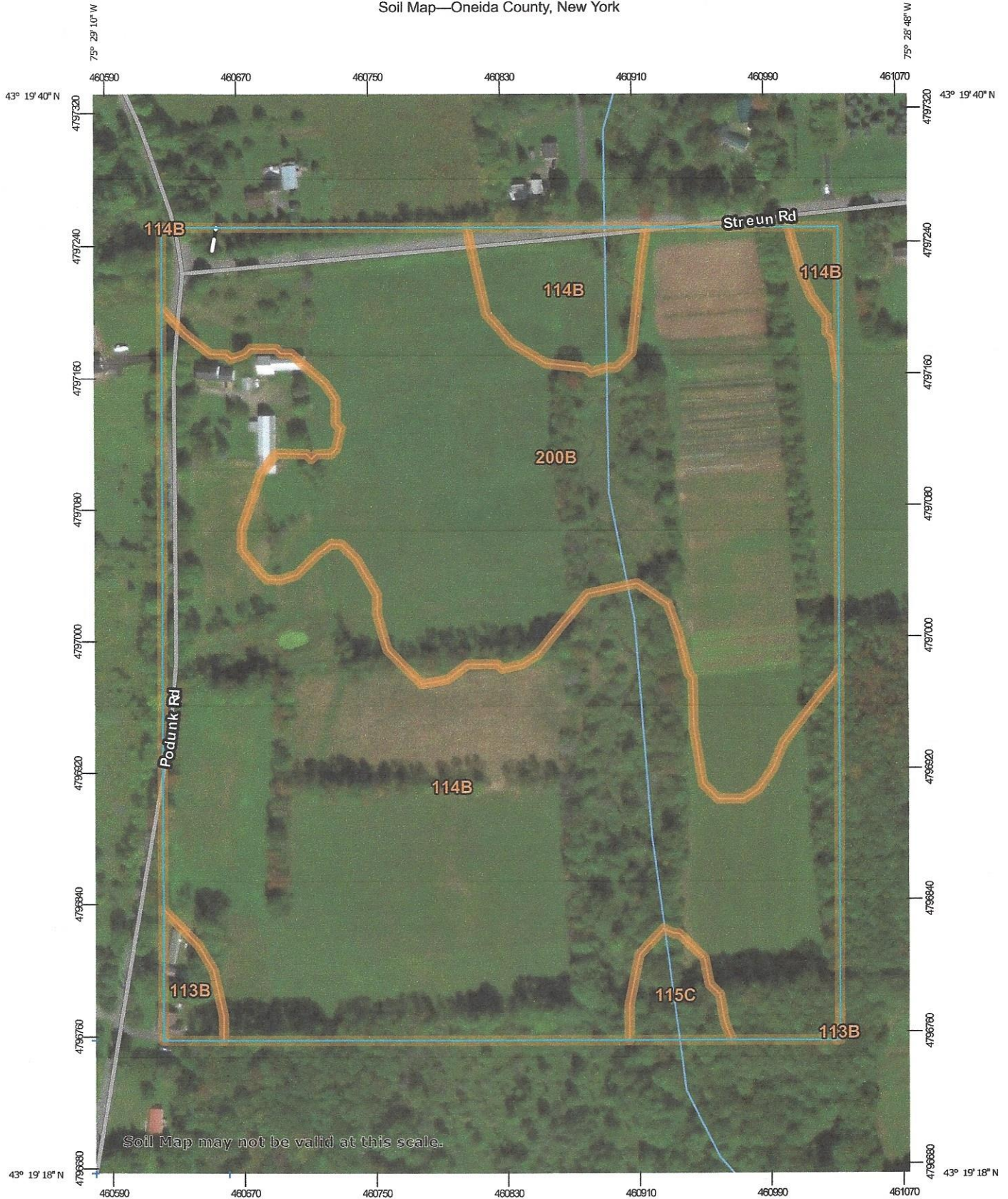

MAP INFORMATION

The soil surveys that comprise your AOI were mapped at 1:24,000.

Warning: Soil Map may not be valid at this scale.

Enlargement of maps beyond the scale of mapping can cause misunderstanding of the detail of mapping and accuracy of soil line placement. The maps do not show the small areas of contrasting soils that could have been shown at a more detailed scale.

Please rely on the bar scale on each map sheet for map measurements.

Source of Map: Natural Resources Conservation Service
 Web Soil Survey URL:
 Coordinate System: Web Mercator (EPSG:3857)

Maps from the Web Soil Survey are based on the Web Mercator projection, which preserves direction and shape but distorts distance and area. A projection that preserves area, such as the Albers equal-area conic projection, should be used if more accurate calculations of distance or area are required.

This product is generated from the USDA-NRCS certified data as of the version date(s) listed below.



Soil Survey Area: Oneida County, New York
 Survey Area Data: Version 20, Sep 3, 2018

Soil map units are labeled (as space allows) for map scales 1:50,000 or larger.

Date(s) aerial images were photographed: Nov 3, 2013—Sep 27, 2016

The orthophoto or other base map on which the soil lines were compiled and digitized probably differs from the background imagery displayed on these maps. As a result, some minor shifting of map unit boundaries may be evident.

MAP LEGEND

- | | |
|------------------------------------------------------------------------------------------------------------|-----------------------------------------------------------------------------------------------------------|
|  Area of Interest (AOI) |  Spoil Area |
|  Soils |  Stony Spot |
|  Soil Map Unit Polygons |  Very Stony Spot |
|  Soil Map Unit Lines |  Wet Spot |
|  Soil Map Unit Points |  Other |
|  Special Point Features |  Special Line Features |
|  Blowout |  Streams and Canals |
|  Borrow Pit |  Transportation |
|  Clay Spot |  Rails |
|  Closed Depression |  Interstate Highways |
|  Gravel Pit |  US Routes |
|  Gravelly Spot |  Major Roads |
|  Landfill |  Local Roads |
|  Lava Flow |  Background |
|  Marsh or swamp |  Aerial Photography |
|  Mine or Quarry | |
|  Miscellaneous Water | |
|  Perennial Water | |
|  Rock Outcrop | |
|  Saline Spot | |
|  Sandy Spot | |
|  Severely Eroded Spot | |
|  Sinkhole | |
|  Slide or Slip | |
|  Sodic Spot | |

Map Unit Legend

| Map Unit Symbol | Map Unit Name | Acres in AOI | Percent of AOI |
|------------------------------------|---------------------------------------------|--------------|----------------|
| 113B | Camroden silt loam, 3 to 8 percent slopes | 0.5 | 1.0% |
| 114B | Pinckney silt loam, 3 to 8 percent slopes | 28.3 | 56.1% |
| 115C | Chadakoin silt loam, 8 to 15 percent slopes | 0.7 | 1.5% |
| 200B | Bice fine sandy loam, 3 to 8 percent slopes | 20.8 | 41.4% |
| Totals for Area of Interest | | 50.4 | 100.0% |